

‘00000-Guide2Source-PDF’

This PDF file introduces you how to use Guide2Source Webpage by the **following 19 example pages** with Red Highlighted comments.

It's webmaster is Fred E. Wahl wahlfred9@gmail.com
Contact Fred if you wish to become a ‘user’ of this site or you have some Product Catalogs you want installed into it for shared-with-public use.

Optional support for Guide2Source:
(only if you found it helpful)

[\[Leave a small thank-you gift \]](#)

Catalogs to be installed if already in PDF format should be emailed to him. If you have only a spare copy of a paper Product Catalog mail it to him. In email ask him for his snail-mail address.

Two types of ‘Product’ files are displayed in “Catalogs” pages.
Type a) are text searchable full Catalog PDFs from a Supplier.
Type b) are PDFs created by the webmaster such as this one.

Standard PDF file Naming Method used in guide2source.com is:

"sort code"-"Supplier"-"Catalog or Brochure Name with date or volume"-"Item Types"

example: 00022-RAF -RafRoundSpacers - Spacers.pdf

note: "sort code" helps to alphabetically arrange files in useful orders.

Other example "sort codes" might be:

00000 this file

00123

0089Z

Webmaster keeps <spaces> out of each "name field",

He uses Capitals and Lowercase to combine words into a particular "name field".

example: for a "catalog Name" -RafRoundSpacers

**The following 19 pages show how to use the site.
Red highlighted arrows with text show how various
buttons may be used.**

Home · Welcome to Guide2Source

Your resource to use text-searchable Product Catalogs.

Once you select and download any PDF file you can use your PDF viewer ^F tool to type-in your search.

Have your Teams favorite Product Catalogs installed here.

Selected user: **public**

Select User (Phase 1)

View & Select Catalogs (Phase 2)

Search for ItemID (Phase 3)

**Typical Items
for Sale
found in
PDF Catalogs**

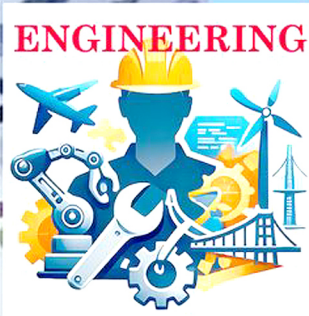

Phase 1 · Pick User

User:

public ▾

Go to Phase 2

Go to Phase 3

Selecte fred

Catalog 1/fredwahl/public_html/guide2source/htdocs/users/public/catalogs (ok)

items_in 1/fredwahl/public_html/guide2source/htdocs/users/public/items_index.csv (ok)

public

[Open Phase 2](#) [Open Phase 3](#) [Clear cache](#)

User: **public** · [Home](#)

Phase 2 · Catalogs

As user = 'fred' instead of 'public'
has many more Product PDAF's
4 pages worth, 10 per 'page'

Total PDFs: 35 · [Sort](#) · [Name](#) | [Date](#) | [Size](#)

User: · [public](#) · [fred](#) · [jim](#) · [jeanne](#) · [User switcher](#) · [Home](#)

Filter by filename (case-insensitive): [Filter](#) — AND use select boxes below.

Select	Catalog (PDF/XLSX)	Size	Modified	Supplier	Status	Website	Email(s)	Phone(s)
<input type="checkbox"/>	00000-Guide2Source-HomeAbout112025-InstallYourCatalogs.pdf	23,023 KB	2025-11-23 18:34	Guide2Source		www.guide2source.com	n/a	n/a
	0000b-104SuppliersOn8Tabs-ItemIDsAndDescriptionsXreffedAcrossSuppliers-ElectronicFasteners.xlsx	1,449 KB	2026-01-05 17:04	104 different Suppliers		n/a	n/a	n/a
<input type="checkbox"/>	0000c-ChatGPT-OpenAlchatGPTfreeLogin-ArtificialIntelligentTool.pdf	697 KB	2026-01-11 14:04	ChatGPT		https://chat.openai.com	n/a	n/a
<input type="checkbox"/>	0000i-WogwoeSounds-StreamFreeMP3audioRecordings-Mp3Mp4byFred.pdf	400 KB	2026-01-18 16:55	Wogwoe Productions		https://www.wogwoe.com/Sounds/	n/a	n/a
<input type="checkbox"/>	0000j-AppleTechnologyTrainer-JessHutchins-PrivateZoomOrGroupTrainingAndRepairForAppleDevices.pdf	437 KB	2026-01-31 13:45	Jess Hutchins Consulting		https://hnhtraining.com	jess@hnhtraining.com	806-759-1161
<input type="checkbox"/>	0000k-NCHsoftware-NCHwindowsMacSoftware-HighlyRecommenedInexpensiveSoftwareTools.pdf	239 KB	2026-02-15 09:56	NCH Software		https://www.nchsoftware.com/	n/a	n/a
<input type="checkbox"/>	0001a-FastenerTrainingInstitute-BasicTrainingGuide2009-Education.pdf	25,936 KB	2025-11-03 16:54	Fastener Training Institute		n/a	n/a	n/a
<input type="checkbox"/>	0001b-Monroe-Website-MajorDistributor.pdf	2,103 KB	2025-09-15 08:51			n/a	n/a	n/a
<input type="checkbox"/>	0001c-Kanebridge-CrossreferenceGuideToOthers-Rivets&Many.pdf	106,768 KB	2024-09-27 13:48	Kanebridge Corporation		www.kanebridge.com	sales@kanebridge.com	888-222-9221
<input type="checkbox"/>	0001d-Keystone-CrossRefGuide#202-.pdf	134,490 KB	2024-07-12 15:13	Keystone		www.keyelco.com	kec@keyco.com	800 221-5510

[Open Phase 3 with selected](#) [Open Phase 4 with selected](#)

(default page shown is page 1)

Phase 2 · Catalogs

Total PDFs: 35 · Sort: [Name](#) | [Date](#) | [Size](#)

User: · [public](#) · [fred](#) · [jim](#) · [jeanne](#) · [User switcher](#) · [Home](#)

Filter by filename (case-insensitive): — **AND use select boxes below.**

Select	Catalog (PDF/XLSX)	Size	Modified	Supplier	Status	Website	Email(s)	Phone(s)
<input type="checkbox"/>	0301-Fastenal-RockRiver9704513Brochure-Tools.pdf	36,052 KB	2026-01-09 12:48	Fastenal		Fastenal.com/RockRiver	n/a	n/a
<input type="checkbox"/>	0303-BambuLabs-BambuLabs3Dprinters-3Dprinters.pdf	271 KB	2026-01-09 16:25	Bambu Labs		www.bambulab.com	n/a	n/a
<input type="checkbox"/>	0304-CNCNonMetals-HobbyistGuideNonMetals-WoodPlasticCapableCNC.pdf	590 KB	2026-01-19 15:02	open PDF		n/a	n/a	n/a
<input type="checkbox"/>	0305-CNCMetals-HobbyistGuideMetalsPics-MetalsCapableCNC.pdf	577 KB	2026-01-19 15:03	open PDF		n/a	n/a	n/a
<input type="checkbox"/>	0306-Pro3Dprinters-PPScCF20filamentType-ExamplesYouTube.pdf	249 KB	2026-01-29 15:37	view YouTube		n/a	n/a	n/a

« First < Prev 1 2 3 **4** Next > Last »



if this '4' is pressed the last page of PDF's is displayed.

Phase 2 · Catalogs

Total PDFs: 35 · Sort: [Name](#) | [Date](#) | [Size](#)

User: [public](#) · [fred](#) · [jim](#) · [jeanne](#) · [User switcher](#) · [Home](#)

Filter by filename (case-insensitive): Filter — AND use select boxes below.

Select	Catalog (PDF/XLSX)	Size	Modified	Supplier	Status	Website	Email(s)	Phone(s)
<input type="checkbox"/>	0034-Marlboro-IndustrialHingesCatalogDec2016-Hinges.pdf	2,099 KB	2024-04-19 15:01	Marlboro Industrial Hinges		www.marlborohing_e.com	sales@marlboro_hinge.com	1-800-544-2038 330-935-2445
<input type="checkbox"/>	0040-StarStainlessScrew-ReferenceGuideDimensions-ScrewsNutsBoltsWashersCaps - Copy.pdf	57,262 KB	2025-08-06 13:36			n/a	n/a	n/a
<input type="checkbox"/>	0050-KanebridgeCorp-KanebridgeSpecGuide6thEd-Fasteners.pdf	570,771 KB	2025-08-06 14:06	Kanebridge Corporation		www.kanebridge.com	n/a	888-222-9221
<input type="checkbox"/>	0060-Southco-FastenersHandbook39-Assemblies.pdf	472,825 KB	2025-04-30 17:19	Southco Fasteners		https://southco.com/en_us_int/fasteners_c	info@southco.com	610-459-4000
<input type="checkbox"/>	0070-SierraPacific-Henges&IndustrialHardware-HandlesLatchesKnobs.pdf	544,960 KB	2025-05-24 17:22	Sierra Pacific Engineering & Products		www.spep.com	sales@spep.com	310-608-0693
<input type="checkbox"/>	0080-Kanebridge-CrossreferenceGuideToOthers-Rivets&Many.pdf	106,768 KB	2024-09-27 13:48	Kanebridge Corporation		www.kanebridge.com	sales@kanebridge.com	888-222-9221
<input type="checkbox"/>	0090-DZUS-QuickActingFasteners-FastenersLatches.pdf	145,632 KB	2024-08-16 13:07	DZUS Fastener Co. Inc.		n/a	n/a	516-669-0494
<input type="checkbox"/>	0157-CofanUSA-DCBrushlessAxialFans-Fans.pdf	13,501 KB	2024-12-31 15:53	COFAN USA		www.cofan-usa.com	info@cofan-usa.com	800-766-6097 510-490-7553
<input type="checkbox"/>	0201-Amatom-ElectronicHardware-StandoffsHandlesWashers.pdf	262,668 KB	2025-02-15 15:52	Carey Mfg/Amatom		https://careymfg.com	sales@amatom.com	800-243-6032
<input type="checkbox"/>	0300-Stanley-Stanley58bp111Catalog-Tools.pdf	23,332 KB	2026-01-09 12:50	StanleyWorks		www.stanleyworks.com	n/a	800-262-2161

if 'Prev' is clicked the previous page of PDFs is displayed

Phase 2 · Catalogs

Total PDFs: 4 - Sort: [Name](#) | [Date](#) | [Size](#)

User: · [public](#) · [fred](#) · [jim](#) · [User switcher](#) · [Home](#)

Filter by filename (case-insensitive): — AND use select boxes below.

Select	Catalog (PDF)	Size	Modified	Supplier	Status	Website	Email(s)	Phone(s)
<input type="checkbox"/>	00000-Guide2Source-HomeAbout110925-InstallYourCatalogs.pdf	13 KB	2025-11-09 18:41					
<input type="checkbox"/>	0001a-FastenerTrainingInstitute-BasicTrainingGuide2009-Education.pdf	25,936 KB	2025-11-03 16:54					
<input checked="" type="checkbox"/>	0003-GREER-nylonInsertLocknuts-Locknuts.pdf	76,355 KB	2024-08-16 13:31					(615) 459-4177
<input type="checkbox"/>	0020-KensForging-ProductCatalog2019-EyeboltsTurnbucklesDrings.pdf	5,577 KB	2025-08-08 23:47			www.kenforging.com	sales@kenforging.com	(440) 993-8091 (440) 992-0360

Phase 3 · Search for ItemIDs

case-insensitive, substring match

User: **public** · [public](#) · [fred](#)

[Back to Phase 2](#) · [Ping](#) · [User switcher](#) · [Clear cache](#) · [Home](#)

Enter an item id above and press Search.

Phase 3 · Search for ItemIDs

- AN364-62
- an364-624
- AN364-634
- an
- an364-
- an3640624

Search

case-insensitive, substring match

AN364-428A	F52NTE-428	AN364B1614A	Y92NTE-1614A	F52NE-918
AN364-524	F52NTE-524			AN365-1018
AN364-524A	F52NTE-524	AN364D632	68NTM-632	AN365-1018A
AN364-624	F52NTE-624	AN364D632A	68NTM-632	AN365-1216
AN364-624A	F52NTE-624	AN364D832	68NTM-832	AN365-1216A
AN364-720	F52NTE-720	AN364D832A	68NTM-832	AN365-1414
AN364-720A	F52NTE-720	AN364D1032	68NTM-1032	AN365-1414A
AN364-820	F52NTE-820	AN364D1032A	68NTM-1032	AN365-1614
AN364-820A	F52NTE-820	AN364D428	68NTE-428	AN365-1614A
		AN364D428A	68NTE-428	AN365-1812
AN364-918	F52NTE-918	AN364D524	68NTE-524	AN365-1812A
AN364-918A	F52NTE-918	AN364D524A	68NTE-524	AN365-2012
AN364-1018	F52NTE-1018	AN364D624	68NTE-624	AN365-2012A
AN364-1018A	F52NTE-1018	AN364D624A	68NTE-624	
AN364-1216	F52NTE-1216	AN364D720	68NTE-720	AN365B440
AN364-1216A	F52NTE-1216	AN364D720A	68NTE-720	AN365B440A
AN364-1414	F52NTE-1414	AN364D820	68NTE-820	AN365B632
AN364-1414A	F52NTE-1414	AN364D820A	68NTE-820	AN365B632A
AN364-1614	F52NTE-1614	AN364D918	68NTE-918	AN365B832
AN364-1614A	F52NTE-1614	AN364D918A	68NTE-918	AN365B832A
AN364-1812	F52NTE-1812	AN364D1018	68NTE-1018	AN365B1032
AN364-1812A	F52NTE-1812	AN364D1018A	68NTE-1018	AN365B1032A
AN364-2012	F52NTE-2012	AN364D1216	68NTE-1216	AN365B428
AN364-2012A	F52NTE-2012	AN364D1216A	68NTE-1216	AN365B428A
		AN364D1414	68NTE-1414	AN365B524
AN364B836	Y92NTM-836	AN364D1414A	68NTE-1414	AN365B524A
AN364B836A	Y92NTM-836	AN364D1614	68NTE-1614	AN365B624
AN364B1032	Y92NTM-1032	AN364D1614A	68NTE-1614	AN365B624A
AN364B1032A	Y92NTM-1032			AN365B720
AN364B428	Y92NTE-428	AN365-440	F22NM-440	AN365B720A
AN364B428A	Y92NTE-428	AN365-440A	F22NM-440	AN365B820
AN364B524	Y92NTE-524	AN365-632	F22NM-632	AN365B820A
AN364B524A	Y92NTE-524	AN365-632A	F22NM-632	AN365B918
AN364B624	Y92NTE-624	AN365-832	F22NM-832	AN365B918A
AN364B624A	Y92NTE-624	AN365-832A	F22NM-832	AN365B1018
AN364B720	Y92NTE-720	AN365-1032	F22NM-1032	AN365B1018A
AN364B720A	Y92NTE-720	AN365-1032A	F22NM-1032	AN365B1216
				Y92NM-440
				Y92NM-440
				Y92NM-632
				Y92NM-632
				Y92NM-832
				Y92NM-832
				Y92NM-1032
				Y92NM-1032
				Y92NE-428
				Y92NE-428
				Y92NE-524
				Y92NE-524
				Y92NE-624
				Y92NE-624
				Y92NE-720
				Y92NE-720
				Y92NE-820
				Y92NE-820
				Y92NE-918
				Y92NE-918
				Y92NE-1018
				Y92NE-1018
				Y92NE-1216

Item ID(s) found

For interchange with Esna part numbers see Page 5.

AN-MS-NAS GREER INTERCHANGEABILITY

Phase 2 · Catalogs

Total PDFs: 3 ♦ - Sort: [Name](#) | [Date](#) | [Size](#)

User: · [public](#) · [fred](#) · [jim](#) · [User switcher](#) · [Home](#)

Filter by filename (case-insensitive): — AND use select boxes below.

Select	Catalog (PDF)	Size	Modified	Supplier	Status	Website	Email(s)	Phone(s)
<input checked="" type="checkbox"/>	0031-FairlaneProducts-QuickReleaseBallLockPinsSept2021-ReleasePinsHandles.pdf	3,146 KB	2024-04-19 14:35					
<input type="checkbox"/>	0070-SierraPacific-Henges&IndustrialHardware-HandlesLatchesKnobs.pdf	544,960 KB	2025-05-24 17:22					
<input checked="" type="checkbox"/>	0201-Amatom-ElectronicHardware-StandoffsHandlesWashers.pdf	262,668 KB	2025-02-15 15:52					

Phase 4 - Multi-catalog item search

User: fred · Catalogs dir: /home1/fredwahl/public_html/guide2source/htdocs/users/fred/catalogs (ok) · items_index.csv: /home1/

[Home](#) [Phase 1](#) [Phase 2](#) [Phase 3](#)

Search Item ID:

Default: case-insensitive substring match on item id.

To use a regular expression, wrap it like /ABC.?123/i.

Catalogs to search (single-column list)

- 0003 - 0003-GREEK-THYTHHISELLOCKTULS-LOCKTULS
- 0007 - 0007-Thomas&Betts-CatamountTaylor1998-CabletiesFastenersystemsWireducts
- 0009 - 0009-Pemnet-AtlasBlindThreadedInsertsCat616Rev716-Inserts&Tools
- 0020 - 0020-KensForging-ProductCatalog2019-EyeboltsTurnbucklesDrings
- 0031 - 0031-FairlaneProducts-QuickReleaseBallLockPinsSept2021-ReleasePinsHandles
- 0034 - 0034-Marlboro-IndustrialHingesCatalogDec2016-Hinges
- 0040 - 0040-StarStainlessScrew-ReferenceGuideDimensions-ScrewsNutsBoltsWashersCaps - Copy
- 0050 - 0050-KanebridgeCorp-KanebridgeSpecGuide6thEd-Fasteners
- 0060 - 0060-Southco-FastenersHandbook39-Assemblies

List is ordered by catalog number (file prefix).

Enter an Item ID above, choose catalogs, and press Search.

Auto-selected 2 catalogs from Phase 2.

Phase 4 · Multi-catalog item search

User: fred · Catalogs dir: /home1/fredwahl/public_html/guide2source/htdocs/users/fred/catalogs (ok) · items_index.csv: /home1/fredwahl

[Home](#) [Phase 1](#) [Phase 2](#) [Phase 3](#)

Search Item ID:

Default: case-insensitive substring match on item id.
To use a regular expression, wrap it like /ABC. ?123/i.

Catalogs to search (single-column list)

- 0003 – 0003-GREER-nylonInsertLocknuts-Locknuts
- 0007 – 0007-Thomas&Betts-CatamountTaylor1998-CabletiesFastenersystemsWireducts
- 0009 – 0009-Pemnet-AtlasBlindThreadedInsertsCat616Rev716-Inserts&Tools
- 0020 – 0020-KensForging-ProductCatalog2019-EyeboltsTurnbucklesDrings
- 0031 – 0031-FairlaneProducts-QuickReleaseBallLockPinsSept2021-ReleasePinsHandles
- 0034 – 0034-Marlboro-IndustrialHingesCatalogDec2016-Hinges
- 0040 – 0040-StarStainlessScrew-ReferenceGuideDimensions-ScrewsNutsBoltsWashersCaps - Copy
- 0050 – 0050-KanebridgeCorp-KanebridgeSpecGuide6thEd-Fasteners
- 0060 – 0060-Southco-FastenersHandbook39 Assemblies

List is ordered by catalog number (file prefix).

Results for **mbaas-10-** · Catalogs searched: 2 · Matches: 26 (showing 1 – 25)

Pages: « Prev [1](#) [2](#) Next »

1. [MBAAS-10-015](#) (Catalog 0031 · Page 16)
mm mm mm mm mm mm **mbaas-10-015** MBACH-10-015 10 9.96 9.92
2. [MBAAS-10-020](#) (Catalog 0031 · Page 16)
25.7 14.2 17.8 7.4 25.4 **mbaas-10-020** MBACH-10-020 10 9.96 9.92
3. [MBAAS-10-025](#) (Catalog 0031 · Page 16)
25.7 14.2 17.8 7.4 25.4 **mbaas-10-025** MBACH-10-025 10 9.96 9.92
4. [MBAAS-10-030](#) (Catalog 0031 · Page 16)
25.7 14.2 17.8 7.4 25.4 **mbaas-10-030** MBACH-10-030 10 9.96 9.92

Click 1. 'blue' to see that catalog page with the ItemID highlighted

GoogleSearch-like results found list

most complete near top of list – 1.

Aluminum Button Handle | Metric (continued)

MA MODIFICATIONS AVAILABLE

EXPANDED LINE

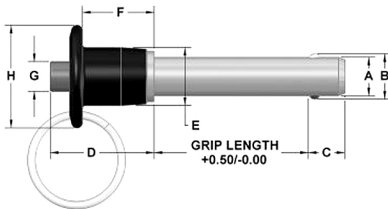

Dia mm	Hole Size		Min. Pull-Out Strength (N)	Calculated Double Shear (N)	
	Max mm	Min mm		4130 Steel	17-4 Stainless
5	5.1	5.0	890	21,600	24,400
6	6.1	6.0	1,023	31,686	35,640
8	8.1	8.0	2,268	56,712	63,804
10	10.1	10.0	2,558	88,977	100,101
12	12.1	12.0	5,160	128,050	144,060
16	16.1	16.0	9,207	228,602	257,179

4130 Steel Part #	17-4 SS Part #	Nominal Diameter mm	A Max mm	A Min mm	Grip Length mm	+/-0.25 B mm	+/-1.0 C mm	D mm	E mm	F mm	G mm	H mm
MBAAS-10-015	MBACH-10-015	10	9.96	9.92	15	11.86	9	25.7	14.2	17.8	7.4	25.4
MBAAS-10-020	MBACH-10-020	10	9.96	9.92	20	11.86	9	25.7	14.2	17.8	7.4	25.4
MBAAS-10-025	MBACH-10-025	10	9.96	9.92	25	11.86	9	25.7	14.2	17.8	7.4	25.4
MBAAS-10-030	MBACH-10-030	10	9.96	9.92	30	11.86	9	25.7	14.2	17.8	7.4	25.4
MBAAS-10-035	MBACH-10-035	10	9.96	9.92	35	11.86	9	25.7	14.2	17.8	7.4	25.4
MBAAS-10-040	MBACH-10-040	10	9.96	9.92	40	11.86	9	25.7	14.2	17.8	7.4	25.4
MBAAS-10-045	MBACH-10-045	10	9.96	9.92	45	11.86	9	25.7	14.2	17.8	7.4	25.4
MBAAS-10-050	MBACH-10-050	10	9.96	9.92	50	11.86	9	25.7	14.2	17.8	7.4	25.4
MBAAS-10-060	MBACH-10-060	10	9.96	9.92	60	11.86	9	25.7	14.2	17.8	7.4	25.4
MBAAS-10-070	MBACH-10-070	10	9.96	9.92	70	11.86	9	25.7	14.2	17.8	7.4	25.4
MBAAS-10-080	MBACH-10-080	10	9.96	9.92	80	11.86	9	25.7	14.2	17.8	7.4	25.4
MBAAS-10-090	MBACH-10-090	10	9.96	9.92	90	11.86	9	25.7	14.2	17.8	7.4	25.4
MBAAS-10-100	MBACH-10-100	10	9.96	9.92	100	11.86	9	25.7	14.2	17.8	7.4	25.4
MBAAS-12-020	MBACH-12-020	12	11.96	11.92	20	14.45	10	32.3	18.3	21.6	10.7	34.7
MBAAS-12-025	MBACH-12-025	12	11.96	11.92	25	14.45	10	32.3	18.3	21.6	10.7	34.7
MBAAS-12-030	MBACH-12-030	12	11.96	11.92	30	14.45	10	32.3	18.3	21.6	10.7	34.7
MBAAS-12-035	MBACH-12-035	12	11.96	11.92	35	14.45	10	32.3	18.3	21.6	10.7	34.7
MBAAS-12-040	MBACH-12-040	12	11.96	11.92	40	14.45	10	32.3	18.3	21.6	10.7	34.7
MBAAS-12-045	MBACH-12-045	12	11.96	11.92	45	14.45	10	32.3	18.3	21.6	10.7	34.7
MBAAS-12-050	MBACH-12-050	12	11.96	11.92	50	14.45	10	32.3	18.3	21.6	10.7	34.7
MBAAS-12-060	MBACH-12-060	12	11.96	11.92	60	14.45	10	32.3	18.3	21.6	10.7	34.7
MBAAS-12-070	MBACH-12-070	12	11.96	11.92	70	14.45	10	32.3	18.3	21.6	10.7	34.7
MBAAS-12-080	MBACH-12-080	12	11.96	11.92	80	14.45	10	32.3	18.3	21.6	10.7	34.7
MBAAS-12-090	MBACH-12-090	12	11.96	11.92	90	14.45	10	32.3	18.3	21.6	10.7	34.7
MBAAS-12-100	MBACH-12-100	12	11.96	11.92	100	14.45	10	32.3	18.3	21.6	10.7	34.7
MBAAS-16-025	MBACH-16-025	16	15.96	15.92	25	19	14	41.9	23.9	27.9	13.7	44.5
MBAAS-16-030	MBACH-16-030	16	15.96	15.92	30	19	14	41.9	23.9	27.9	13.7	44.5
MBAAS-16-035	MBACH-16-035	16	15.96	15.92	35	19	14	41.9	23.9	27.9	13.7	44.5
MBAAS-16-040	MBACH-16-040	16	15.96	15.92	40	19	14	41.9	23.9	27.9	13.7	44.5
MBAAS-16-045	MBACH-16-045	16	15.96	15.92	45	19	14	41.9	23.9	27.9	13.7	44.5
MBAAS-16-050	MBACH-16-050	16	15.96	15.92	50	19	14	41.9	23.9	27.9	13.7	44.5
MBAAS-16-060	MBACH-16-060	16	15.96	15.92	60	19	14	41.9	23.9	27.9	13.7	44.5
MBAAS-16-070	MBACH-16-070	16	15.96	15.92	70	19	14	41.9	23.9	27.9	13.7	44.5

Phase 4 · Multi-catalog item search

User: **jim** · Catalogs dir: /home1/fredwahl/public_html/guide2source/htdocs/users/jim/catalogs (ok) · items_index.csv: (ok)

[Home](#) [Phase 1](#) [Phase 2](#) [Phase 3](#)

**Can type in a normal string for ItemID
or use a 'REGEX' type flexible command**

Search Item ID:

Tip: normal searches are flexible. For advanced regex, start with ~. Example: ~^MBAAS (IDs starting with MBAAS)

Tip: ~ for regex (e.g., ~^MBAAS)

Search

Catalogs to search (single-column list)

Select all

Select none

- 0009 – 0009-Pemnet-AtlasBlindThreadedInsertsCat616Rev716-Inserts&Tools
- 0020 – 0020-KensForging-ProductCatalog2019-EyeboltsTurnbucklesDrings
- 0031 – 0031-FairlaneProducts-QuickReleaseBallLockPinsSept2021-ReleasePinsHandles
- 0034 – 0034-Marlboro-IndustrialHingesCatalogDec2016-Hinges
- 0040 – 0040-StarStainlessScrew-ReferenceGuideDimensions-ScrewsNutsBoltsWashersCaps
- 0050 – 0050-KanebridgeCorp-KanebridgeSpecGuide6thEd-Fasteners
- 0060 – 0060-Southco-FastenersHandbook39-Assemblies
- 0070 – 0070-SierraPacific-Henges&IndustrialHardware-HandlesLatchesKnobs
- 0080 – 0080-Kanebridge-CrossreferenceGuideToOthers-Rivets&Manv

List is ordered by catalog number (file prefix).

Enter an Item ID above, choose catalogs, and press Search.

Auto-selected 1 catalogs from Phase 2.

Phase 4 · Multi-catalog item search

User: jim · Catalogs dir: /home1/fredwahl/public_html/guide2source/htdocs/users/jim/catalogs (ok) · items_index.csv: /home1/fredwahl/public_html/guide2source/htdocs/users/jim/catalogs/items_index.csv (ok)

[Home](#) [Phase 1](#) [Phase 2](#) [Phase 3](#)

Search Item ID:

Tip: normal searches are flexible. For advanced regex, start with ~ Example: ^MBAAS (IDs starting with MBAAS)

example REGEX commands:

~^MBAAS

~MBAAS-10-[0-9]+

~\bMBAAS-10-015\b

(MBAAS | MBACH)

Catalogs to search (single-column list)

some characters need to be 'escaped':

~\bMBAAS-10-015\b

~MBAAS[\s\-\ \.]*10[\s\-\ \.]*015

~MBAAS-10-\d+

- 0009 – 0009-Pemnet-AtlasBlindThreadedInsertsCat616Rev716-Inserts&Tools
- 0020 – 0020-KensForging-ProductCatalog2019-EyeboltsTurnbucklesDrings
- 0031 – 0031-FairlaneProducts-QuickReleaseBallLockPinsSept2021-ReleasePinsHandles
- 0034 – 0034-Marlboro-IndustrialHingesCatalogDec2016-Hinges
- 0040 – 0040-StarStainlessScrew-ReferenceGuideDimensions-ScrewsNutsBoltsWashersCaps
- 0050 – 0050-KanebridgeCorp-KanebridgeSpecGuide6thEd-Fasteners
- 0060 – 0060-Southco-FastenersHandbook39-Assemblies
- 0070 – 0070-SierraPacific-Henges&IndustrialHardware-HandlesLatchesKnobs
- 0080 – 0080-Kanebridge-CrossreferenceGuideToOthers-Rivets&Manv

List is ordered by catalog number (file prefix).

Enter an Item ID above, choose catalogs, and press Search.

Auto-selected 1 catalogs from Phase 2.

Phase 4 · Multi-catalog item search

User: **jim** · Catalogs dir: /home1/fredwahl/public_html/guide2source/htdocs/users/jim/catalogs (ok) · items_index.csv: /home1/fredwahl/public_html/guide2source/htdocs/users/jim/catalogs/items_index.csv (ok)

[Home](#) [Phase 1](#) [Phase 2](#) [Phase 3](#)

Search Item ID:

Tip: normal searches are flexible. For advanced regex, start with ~. Example: ~^MBAAS (IDs starting with MBAAS)

Catalogs to search (single-column list)

- 0009 – 0009-Pemnet-AtlasBlindThreadedInsertsCat616Rev716-Inserts&Tools
- 0020 – 0020-KensForging-ProductCatalog2019-EyeboltsTurnbucklesDrings
- 0031 – 0031-FairlaneProducts-QuickReleaseBallLockPinsSept2021-ReleasePinsHandles
- 0034 – 0034-Marlboro-IndustrialHingesCatalogDec2016-Hinges
- 0040 – 0040-StarStainlessScrew-ReferenceGuideDimensions-ScrewsNutsBoltsWashersCaps
- 0050 – 0050-KanebridgeCorp-KanebridgeSpecGuide6thEd-Fasteners
- 0060 – 0060-Southco-FastenersHandbook39-Assemblies
- 0070 – 0070-SierraPacific-Henges&IndustrialHardware-HandlesLatchesKnobs
- 0080 – 0080-Kanebridge-CrossreferenceGuideToOthers-Rivets&Many

List is ordered by catalog number (file prefix).

Results for **~\bMBAAS-10-015\b** · Catalogs searched: 1 · Matches: 2 (showing 1 – 2)

1. [MBAAS-10-015](#) (Catalog 0031 · Page 16)

mm mm mm mm mm mm MBAAS-10-015 MBACH-10-015 10 9.96 9.92

2. [MBACH-10-015](#) (Catalog 0031 · Page 16)

mm mm mm mm mm MBAAS-10-015 MBACH-10-015 10 9.96 9.92 15

QUICK RELEASE BALL LOCK PINS

Aluminum Button Handle | Metric (continued)

MA MODIFICATIONS AVAILABLE

EXPANDED LINE

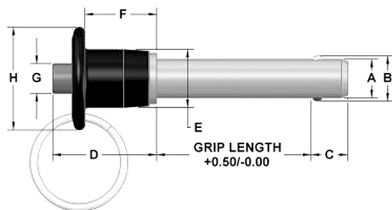

ItemID found

Dia mm	Hole Size Max mm	Hole Size Min mm	Min. Pull-Out Strength (N)	Calculated Double Shear (N)	
				4130 Steel	17-4 Stainless
5	5.1	5.0	890	21,600	24,400
6	6.1	6.0	1,023	31,686	35,640
8	8.1	8.0	2,268	56,712	63,894
10	10.1	10.0	2,558	88,977	100,101
12	12.1	12.0	5,160	128,050	144,060
16	16.1	16.0	9,287	228,602	257,179

4130 Steel Part #	17-4 SS Part #	Nominal Diameter mm	A Max mm	A Min mm	Grip Length mm	+/-0.25 B mm	+/-1.0 C mm	D mm	E mm	F mm	G mm	H mm
MBAAS-10-015	MBACH-10-015	10	9.96	9.92	15	11.86	9	25.7	14.2	17.8	7.4	25.4
MBAAS-10-020	MBACH-10-020	10	9.96	9.92	20	11.86	9	25.7	14.2	17.8	7.4	25.4
MBAAS-10-025	MBACH-10-025	10	9.96	9.92	25	11.86	9	25.7	14.2	17.8	7.4	25.4
MBAAS-10-030	MBACH-10-030	10	9.96	9.92	30	11.86	9	25.7	14.2	17.8	7.4	25.4
MBAAS-10-035	MBACH-10-035	10	9.96	9.92	35	11.86	9	25.7	14.2	17.8	7.4	25.4
MBAAS-10-040	MBACH-10-040	10	9.96	9.92	40	11.86	9	25.7	14.2	17.8	7.4	25.4
MBAAS-10-045	MBACH-10-045	10	9.96	9.92	45	11.86	9	25.7	14.2	17.8	7.4	25.4
MBAAS-10-050	MBACH-10-050	10	9.96	9.92	50	11.86	9	25.7	14.2	17.8	7.4	25.4
MBAAS-10-060	MBACH-10-060	10	9.96	9.92	60	11.86	9	25.7	14.2	17.8	7.4	25.4
MBAAS-10-070	MBACH-10-070	10	9.96	9.92	70	11.86	9	25.7	14.2	17.8	7.4	25.4
MBAAS-10-080	MBACH-10-080	10	9.96	9.92	80	11.86	9	25.7	14.2	17.8	7.4	25.4
MBAAS-10-090	MBACH-10-090	10	9.96	9.92	90	11.86	9	25.7	14.2	17.8	7.4	25.4
MBAAS-10-100	MBACH-10-100	10	9.96	9.92	100	11.86	9	25.7	14.2	17.8	7.4	25.4
MBAAS-12-020	MBACH-12-020	12	11.96	11.92	20	14.45	10	32.3	18.3	21.6	10.7	34.7
MBAAS-12-025	MBACH-12-025	12	11.96	11.92	25	14.45	10	32.3	18.3	21.6	10.7	34.7
MBAAS-12-030	MBACH-12-030	12	11.96	11.92	30	14.45	10	32.3	18.3	21.6	10.7	34.7
MBAAS-12-035	MBACH-12-035	12	11.96	11.92	35	14.45	10	32.3	18.3	21.6	10.7	34.7
MBAAS-12-040	MBACH-12-040	12	11.96	11.92	40	14.45	10	32.3	18.3	21.6	10.7	34.7
MBAAS-12-045	MBACH-12-045	12	11.96	11.92	45	14.45	10	32.3	18.3	21.6	10.7	34.7
MBAAS-12-050	MBACH-12-050	12	11.96	11.92	50	14.45	10	32.3	18.3	21.6	10.7	34.7

Phase 2 - Missing metadata report

This report lists catalogs where **Supplier, Website, Email(s), or Phone(s)** are missing in the metadata table used by Phase 2. Use it as a "bottom-up" checklist: open each catalog, find the real contact info, and update your metadata sources.

PDF files in this user's catalogs folder: **22**

Catalogs with missing Supplier / Website / Email / Phone: **18**

User: jim

Catalog dir: I:\NewWebpage\NewWebpageVS\guide2source\htdocs\users\jim\catalogs

Metadata source: I:\NewWebpage\NewWebpageVS\guide2source\htdocs\phase2/catalogs.csv

#	Catalog (PDF)	Supplier (current)	Status	Missing	Add / edit metadata
1	00000-Guide2Source-Home-InstallYourCatalogs.pdf	Guide2Source		<div style="display: flex; justify-content: space-between;"> Supplier Website Email </div> <div style="display: flex; justify-content: space-between;"> Phone </div>	Supplier: <input type="text" value="Guide2Source"/> Web(s): <input type="text" value="www.guide2source.com"/> Email(s): <input type="text" value="n/a"/> Phone(s): <input type="text" value="n/a"/> <input type="button" value="Save row"/>
2	00000-Guide2Source-HomeAbout110925-InstallYourCatalogs.pdf			<div style="display: flex; justify-content: space-between;"> Supplier Website Email </div> <div style="display: flex; justify-content: space-between;"> Phone </div>	Supplier: <input type="text"/> Web(s): <input type="text" value="www.example.com"/> Email(s): <input type="text" value="sales@example.com"/> Phone(s): <input type="text" value="800-555-1212"/> <input type="button" value="Save row"/>
3	0001a-FastenerTrainingInstitute-BasicTrainingGuide2009-Education.pdf	Fastener Training Institute		<div style="display: flex; justify-content: space-between;"> Supplier Website Email </div> <div style="display: flex; justify-content: space-between;"> Phone </div>	Supplier: <input type="text" value="Fastener Training Institute"/> Web(s): <input type="text" value="www.example.com"/> Email(s): <input type="text" value="sales@example.com"/> Phone(s): <input type="text"/>

1. Webmaster uses this tool to first open a PDF catalog, search that catalog for 'Supplier', 'Web', 'Email' and 'Phone' data then copies and pastes that into these boxes then presses 'Save now'

Phase 2 - Catalogs

Total PDFs: 22 ♦ - Sort: [Name](#) | [Date](#) | [Size](#)

User: · [public](#) · [fred](#) · [jim](#) · [User switcher](#) · [Home](#)

Filter by filename (case-insensitive): — AND use select boxes below.

Select	Catalog (PDF)	Size	Modified	Supplier	Status	Website	Email(s)	Phone(s)
<input type="checkbox"/>	00000-Guide2Source-Home-InstallYourCatalogs.pdf	128 KB	2025-11-13 00:12	Guide2Source		www.guide2source.com	n/a	n/a
<input type="checkbox"/>	00000-Guide2Source-HomeAbout110925-InstallYourCatalogs.pdf	13 KB	2025-11-10 02:41			n/a	n/a	n/a
<input type="checkbox"/>	0001a-FastenerTrainingInstitute-BasicTrainingGuide2009-Education.pdf	25,936 KB	2025-11-04 00:54	Fastener Training Institute		n/a	n/a	n/a
<input type="checkbox"/>	0001b-ElectronicFastenersInc-Website-MajorDistributor.pdf	2,103 KB	2025-09-15 16:51	OneMonroe Engineering		www.electronicfasteners.com	n/a	n/a
<input type="checkbox"/>	0001c-Kanebridge-CrossreferenceGuideToOthers-Rivets&Many.pdf	106,768 KB	2024-09-27 21:48	Kanebridge		www.kanebridge.com	sales@kanebridge.com	888-222-9221
<input type="checkbox"/>	0001d-Keystone-CrossRefGuide#202-.pdf	134,490 KB	2024-07-12 23:13	Keystone		www.keyelco.com	kec@keyco.com	800 221-5510
<input type="checkbox"/>	0002c-StanleyEngineeredFastening-DodgeFasteningSolutions4Plastics2015-Inserts4Plastics.pdf	1,612 KB	2024-03-22 21:30	Stanley Engineered Fastening		www.StanleyEngineeredFastening.com	n/a	n/a
<input type="checkbox"/>	0003-GREER-nylonInsertLocknuts-Locknuts.pdf	76,355 KB	2024-08-16 21:31	GREER		n/a	n/a	(615) 459-4177
<input type="checkbox"/>	0007-Thomas&Betts-CatamountTaylor1998-CabletiesFastenersystemsWireducts.pdf	54,290 KB	2025-03-28 22:59	Thomas&Betts		http://www.tnb.com	n/a	1-800-888-0211
<input type="checkbox"/>	0009-Pemnet-AtlasBlindThreadedInsertsCat616Rev716-Inserts&Tools.pdf	3,236 KB	2024-03-29 20:12			n/a	n/a	n/a